

Free Downloads of Build Instructions,
Assembly Booklets & How To Guides

BuildInstructions.com

15 • Champion • Campeón • Campione • チャンピオン • 勇士

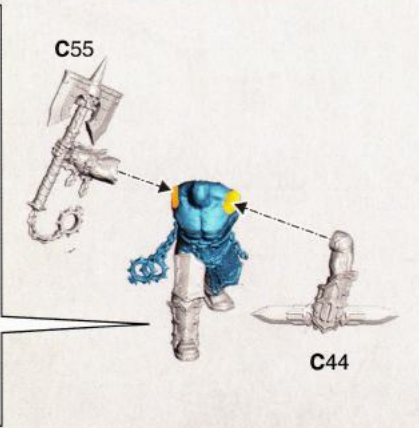
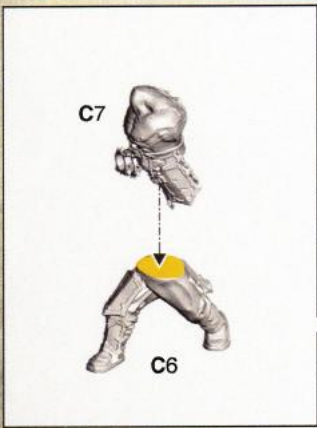

16

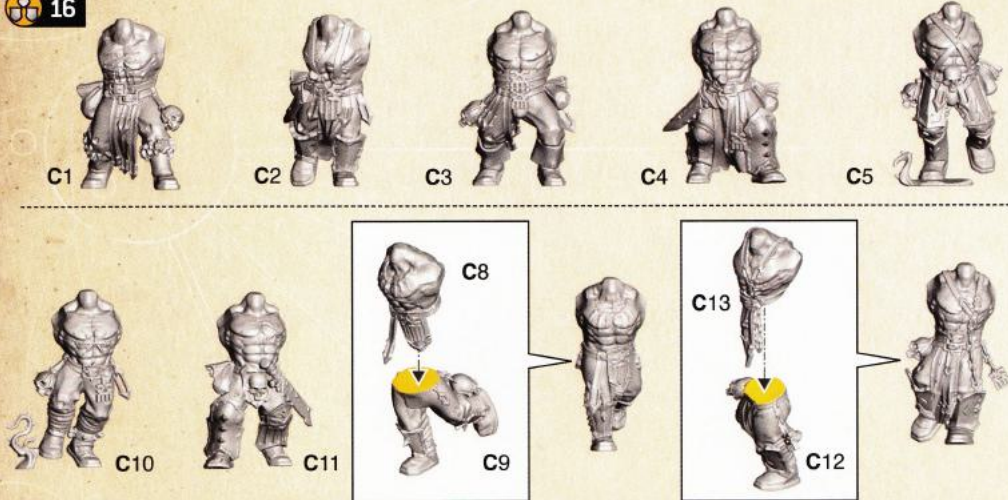

17

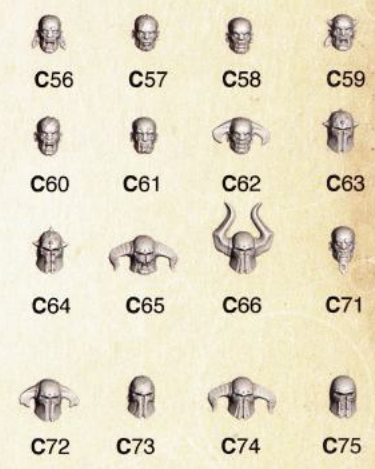

! All models in the unit must be armed with the same weapon option • Toutes les figurines de l'unité doivent avoir la même option d'armes
 • Tutti i modelli devono essere equipaggiati con la stessa opzione d'arma • Alle Modelle dieser Einheit müssen mit derselben Waffenoption bewaffnet sein
 • Tutti i modelli devono essere equipaggiati con la stessa opzione d'arma • ユニットの内のすべての兵が同一の武器オプションを選択すること
 • 该单位中的所有模型必须装备相同的武器选项

18

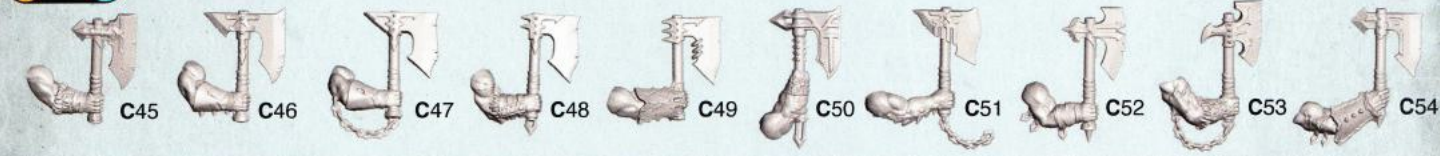

19

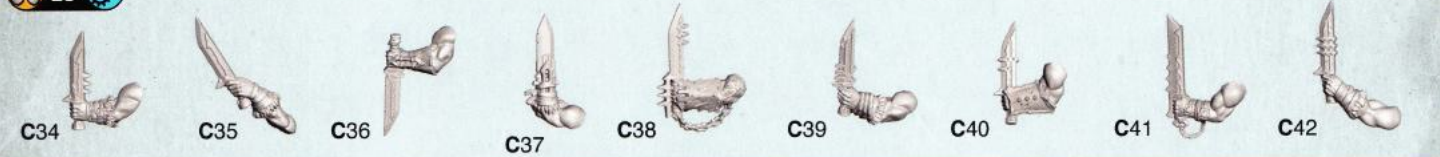

20

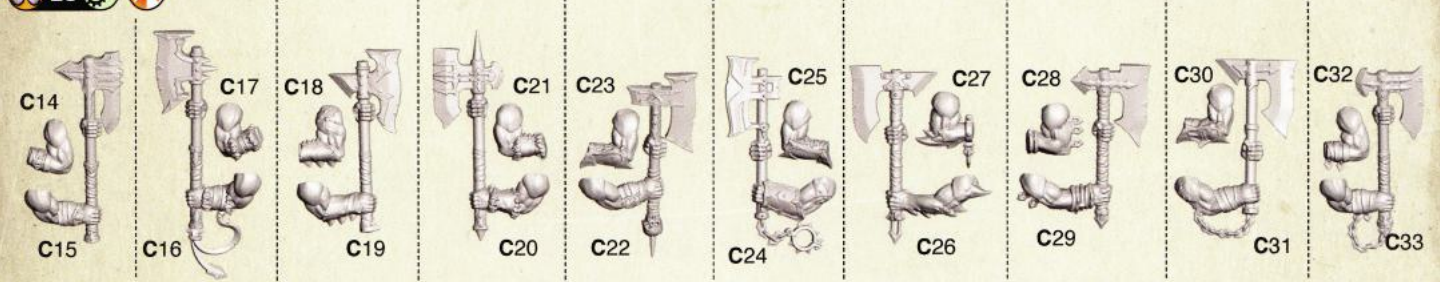

21 • Standard Bearer • Porte-étendard • Portaestandartes • Standartenträger • Alliere • スタンダードベアラー • 旗手

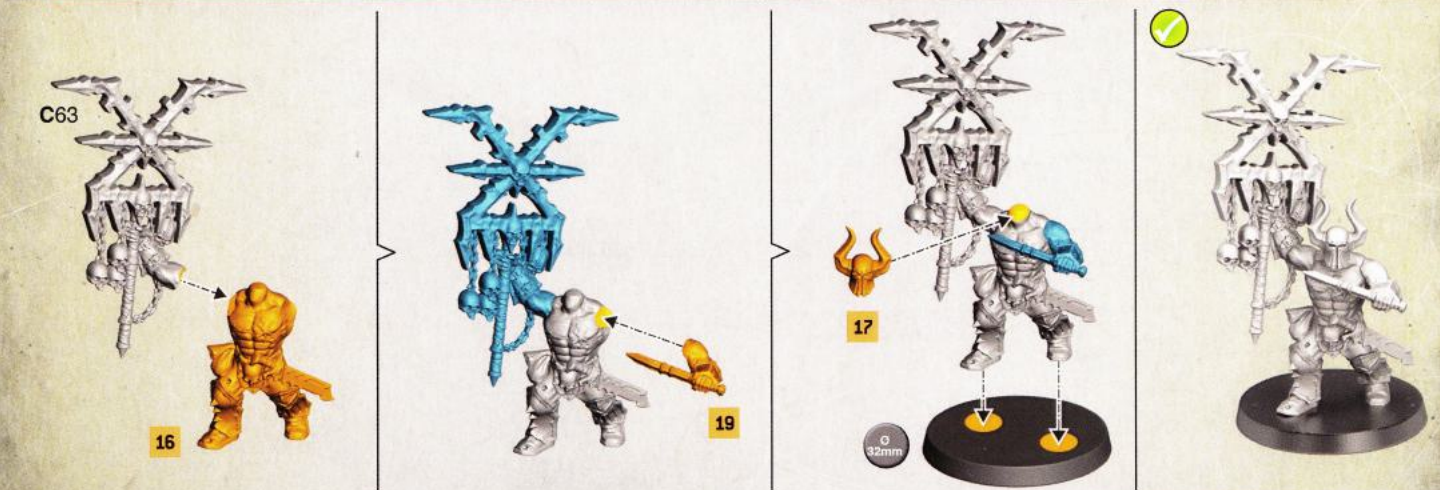

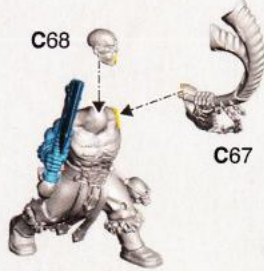

- !**
- Choose the variant you want to build
 - Choisissez la variante à assembler
 - Elige qué versión quieres montar
 - Wähle die Variante, die du bauen möchtest
 - Scegli la variante che vuoi assemblare
 - 組み立てバリエーションの選択
 - 选择你喜欢的拼装方式

23 a



- with Reaver Blades • avec Lames de Pillard • con filos saqueadores
- mit Jägerklingen • con lame dei predoni
- (略奪者の刃装備) • 装备血掠之刃

23 a



- with Meatripper Axe • avec Hache de Déchirure • con hacha descuartizadora
- mit Fleischreißeraxt • con ascia strappacarne
- (肉刻みの斧装備) • 装备撕肉战斧

23 a **x7**



23 a **x7**

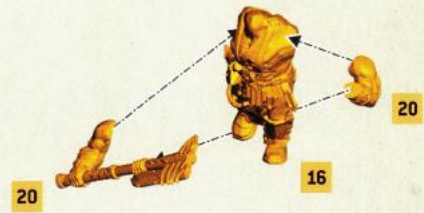

23 b



✓



23 a

