



Free Downloads of Build Instructions,
Assembly Booklets & How To Guides

BuildInstructions.com

WARHAMMER

THE HORUS HERESY



SOLAR AUXILIA

ARVUS LIGHTER

THIS IS NOT A TOY

Not suitable for children under 15 years of age.

WARNING: Resin dust can be harmful if inhaled. Always wear a dust mask or respirator when sanding or sawing resin parts.

Forge World
MINIATURES



CONSTRUCTION GUIDE



COMPONENTS

Before assembly, check that none of the components are missing.

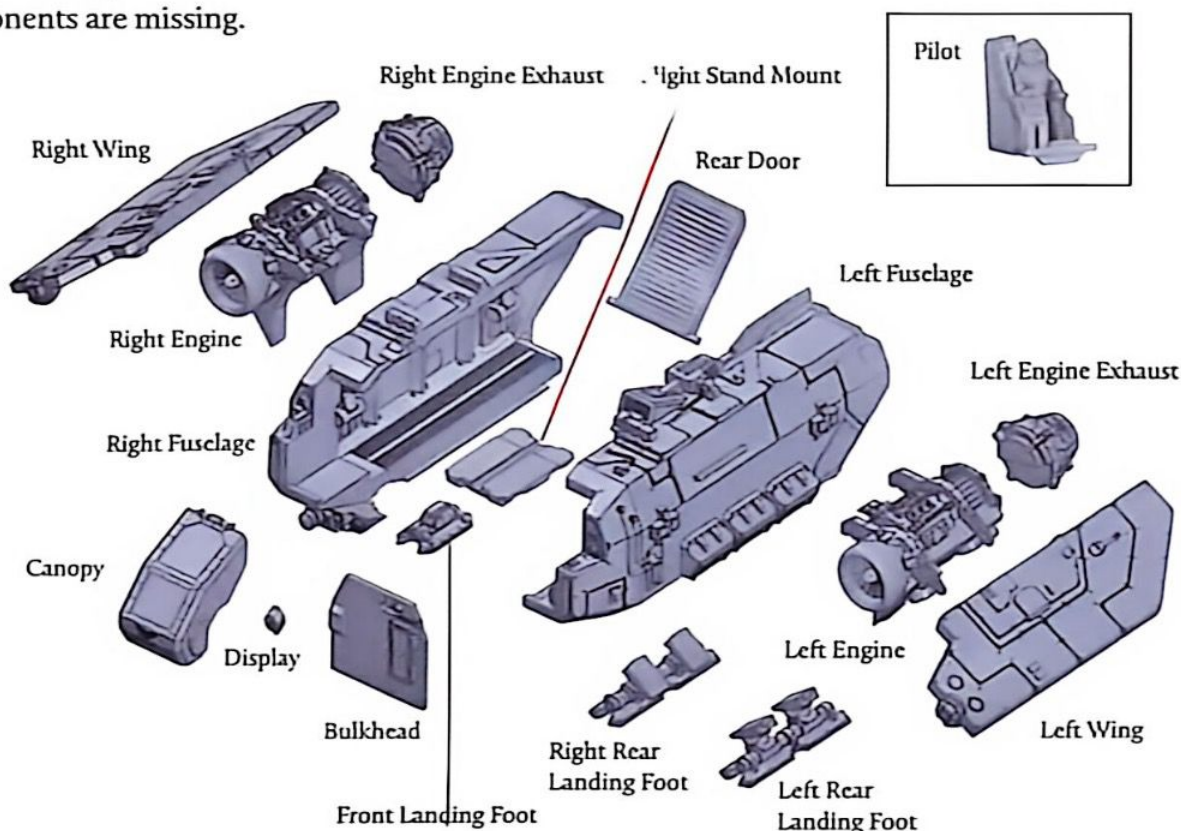

ASSEMBLY LEGEND

Parts for Assembly	
Glue Contact Area	
Shim for Removal	
Insert	
Component Highlight	
Sub-assembly Stage Number	
Do Not Glue	

PREPARING THE MODEL FOR ASSEMBLY

Before assembling the model, wash each part thoroughly with an abrasive brush, such as a toothbrush, to remove any model release agent that may still be on the surface of the parts. Then, remove any excess resin such as mould lines, casting gates, vents and shims. For a more detailed guide to working with resin models, go to the Downloads section of the Warhammer Community website.

This kit contains all the pieces required to construct an Arvus Lighter. To glue the resin pieces together, use super glue.

If you need to contact the Forge World Customer Service team regarding this model, you can get in touch via email - forgeworld@gwplc.com - or call:

0115 900 4995 within the UK

011 44 115 900 4995 from the USA and Canada

0011 44 115 900 4995 from Australia

00 44 115 900 4995 from Europe and the rest of the world.

I

Right Fuselage

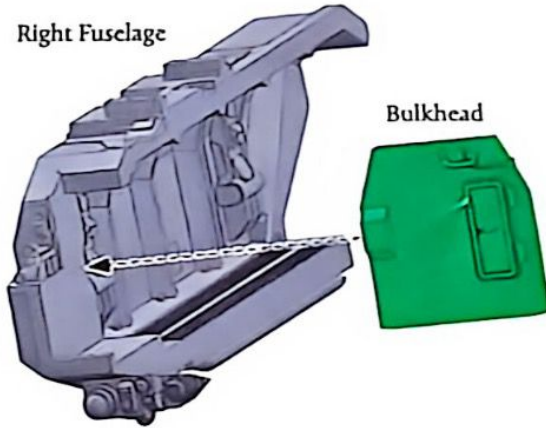

The cargo area can be painted at this stage prior to the two fuselage halves coming together.

2

Rear Door

Left Fuselage

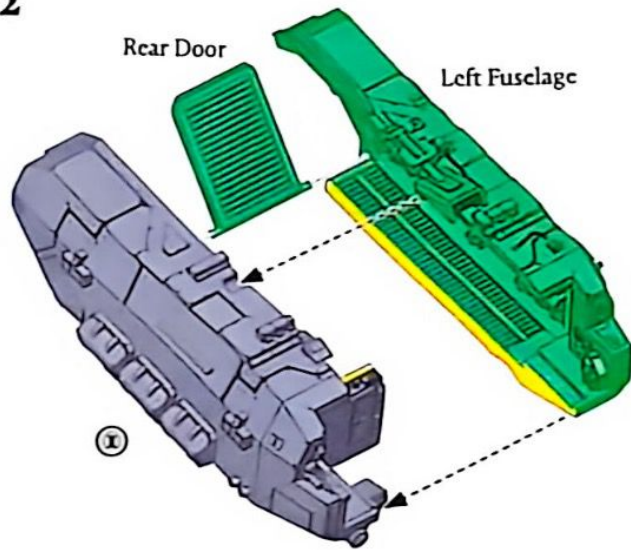

3

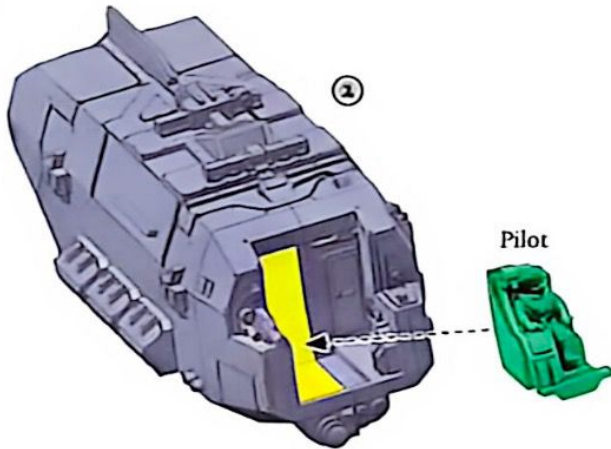

The cockpit interior should be painted at this stage prior to attaching the Canopy.

4

Canopy



We have included a sheet of clear acrylic that you can cut to fit the cockpit windows.

5

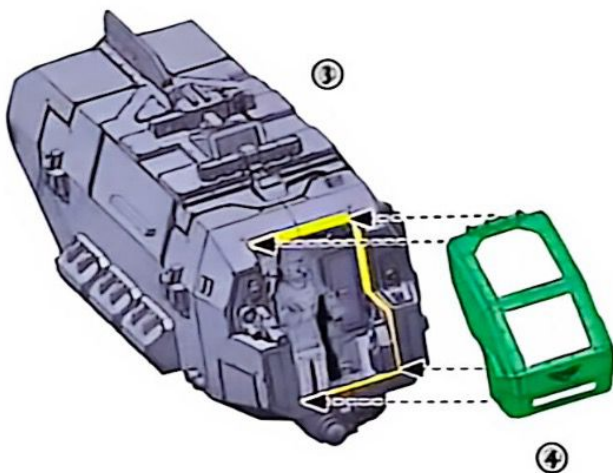

6

Left Engine Exhaust

Left Engine

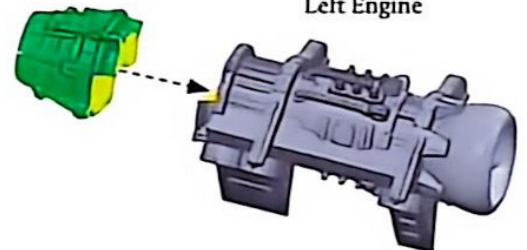

7

Right Engine

Right Engine Exhaust

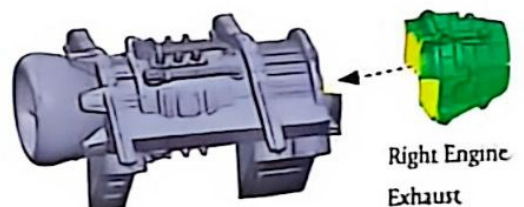

8

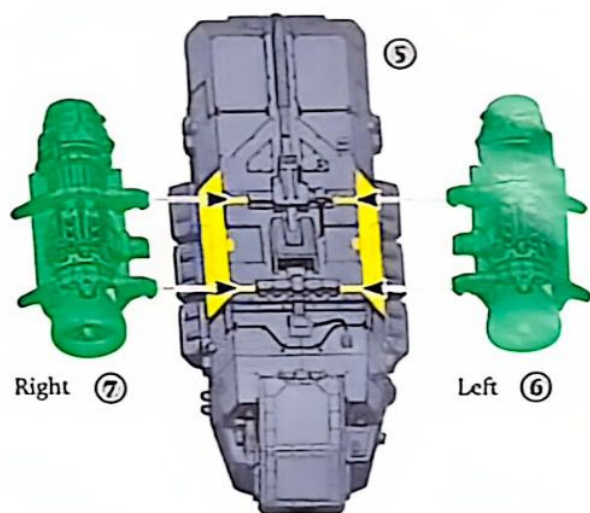

9

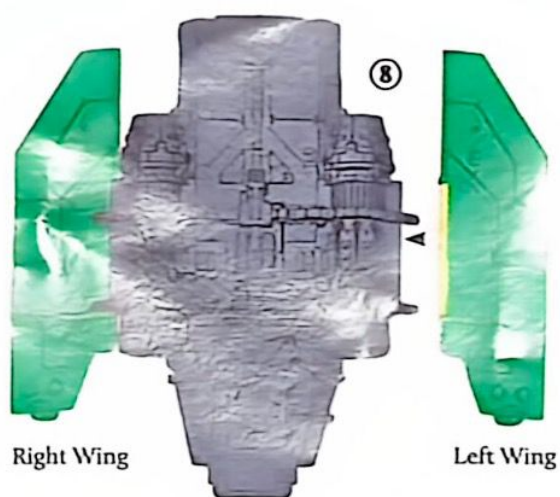

10



11

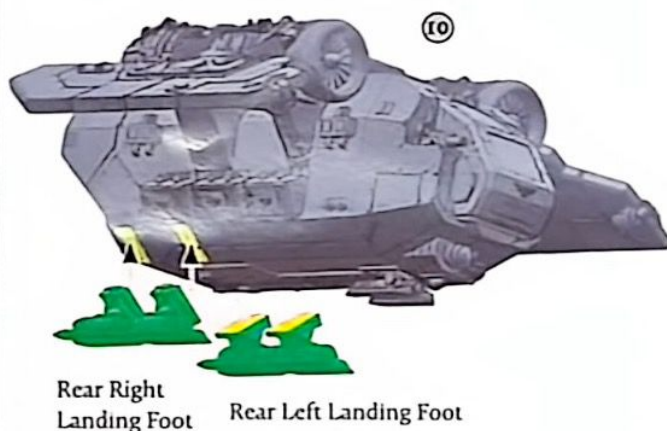

12

