

Free Downloads of Build Instructions,
Assembly Booklets & How To Guides

BuildInstructions.com

IMPERIAL™ ARMOUR

CASTELLAX BATTLE-AUTOMATA

99590108093

CASTELLAX BATTLE-AUTOMATA RESIN COMPONENTS LIST

1. Right Foot
2. Left Foot
3. Left Foot Raised
4. Upper Torso
5. Right Leg
6. Left Leg
7. Sensor Skull
8. Weapon Mount
9. Lower Torso
10. Mauler Bolt Cannon
11. Ammo Box
12. Ammo Feed
13. Hips
14. Left Flamer
15. Right Flamer
16. Left Boiler
17. Right Boiler
18. Shoulder x2
19. Clamp 1 *
20. Clamp 2 *
21. Clamp Piston 1
22. Clamp Piston 2
23. Right Arm Guard
24. Left Arm Guard
25. Arm 1 *
26. Arm 2 *
27. Arm Mount x2

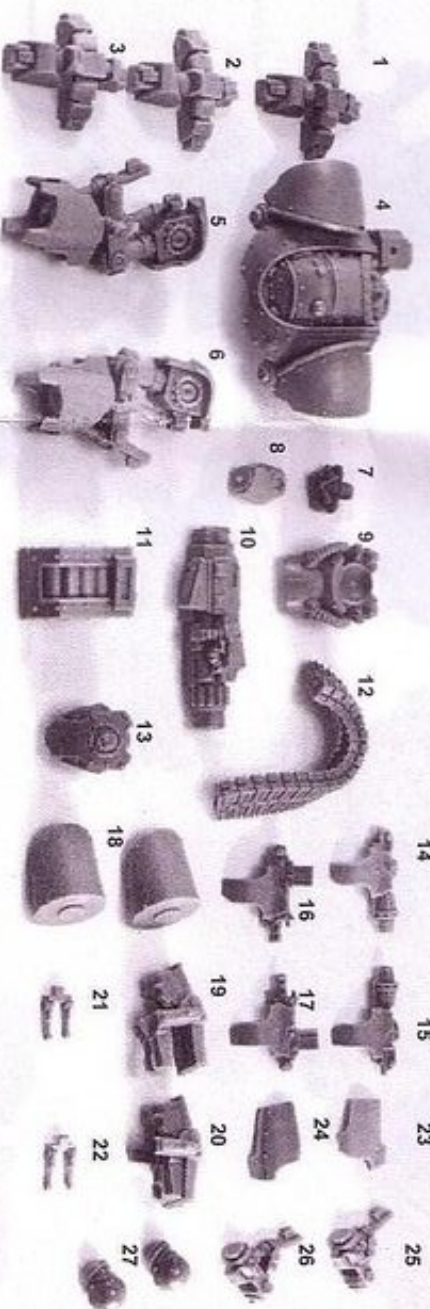

* These items are not sided and can be used for the left or right arm

This kit contains all the pieces required to build the Castellax Battle-Automata
To glue the resin pieces together and to plastic kit parts
use Citadel Super Glue.

NOTE: We have cast this kit using the most advanced techniques
and the best quality resin, but due to the nature of the casting process your
model may contain very slight air bubbles. These can easily be filled with
model filler or super glue. Any slight warpage of thin parts can easily be
corrected by immersing the part in hot tap water for about 1 minute then
carefully bending it back into shape.

THIS IS NOT A TOY

Not suitable for children under 15 years of age.

WARNING: Resin dust can be harmful if inhaled. Always wear a dust
mask or respirator when sanding or sawing resin parts.

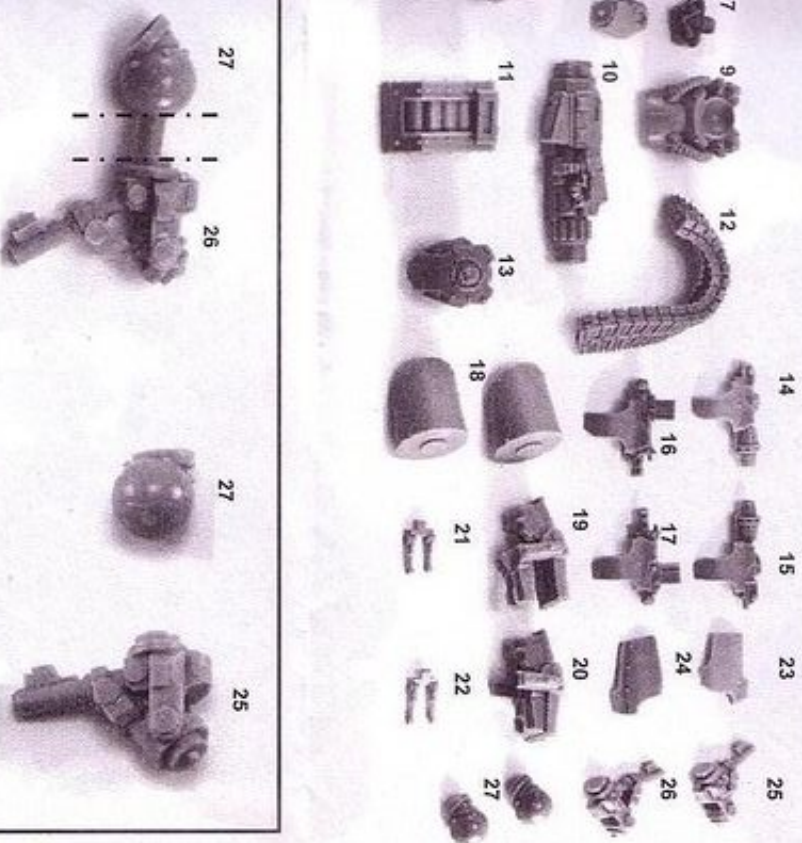

The Arms and Arm Mounts are cast as a single piece. Divide them as shown
above

The copyright on the model designs and components within
this box is the exclusive property of Games Workshop Ltd.
Copyright Games Workshop Ltd., 2013. All rights reserved.

4. Upper Torso

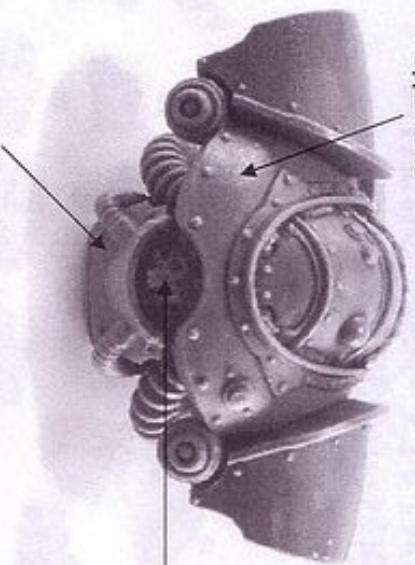

7. Sensor Skull

9. Lower Torso

6. Left Leg



6. Left Leg

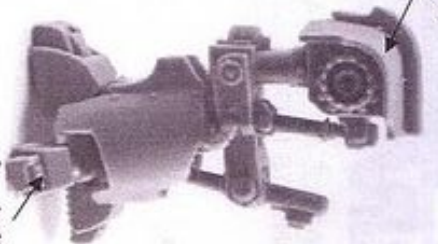

3. Left Foot Raised

The left foot has two options available. One for a static pose and a raised one for a walking pose.

10. Mauler Bolt Cannon

8. Weapon Mount



13. Hips

11. Ammo Box

12. Ammo Feed

If the Ammo Feed does not initially fit into the Mauler Bolt Cannon (as shown above), simply apply some gentle heat to the Ammo Feed either using a hair dryer or hot water and bend the Ammo Feed to the Mauler Bolt Cannon (as shown below)



22. Clamp Piston 2



21. Clamp Piston 1



17. Right Bolter



19. Clamp 1



27. Arm Mount



25. Arm 1



18. Shoulder

18. Shoulder

Arm Assemblies

Arm Assemblies

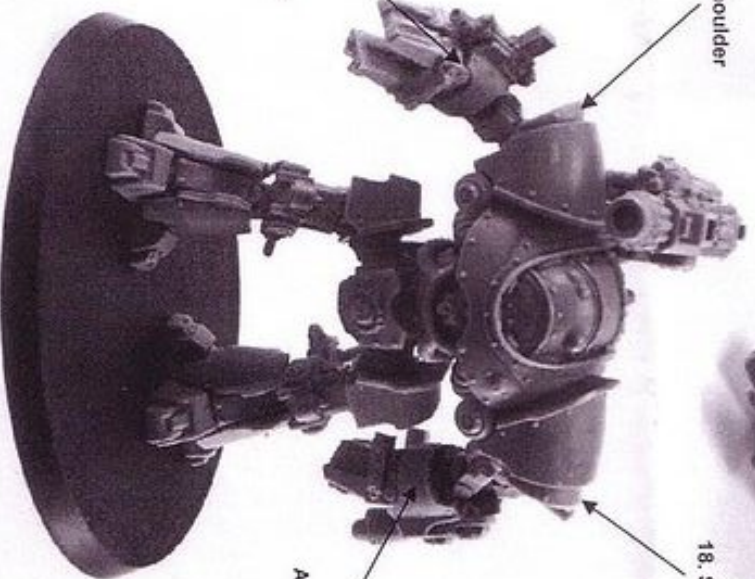

14. Left Flamer



23. Right Arm Guard



24. Left Arm Guard

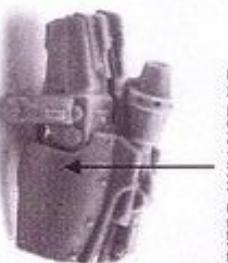

27. Arm Mount



26. Arm 2



18. Shoulder

Arm Assemblies

